

DETAIL OF SEPTIC TANK (SOAK PITS)
SCALE=1:100

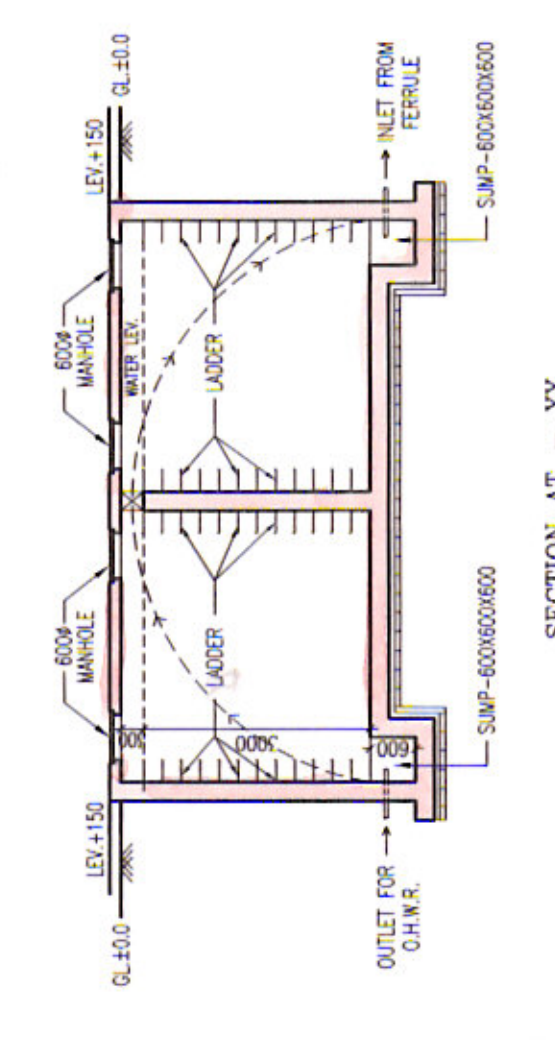

DETAIL OF SEPTIC TANK (SOAK PITS)
SCALE=1:100

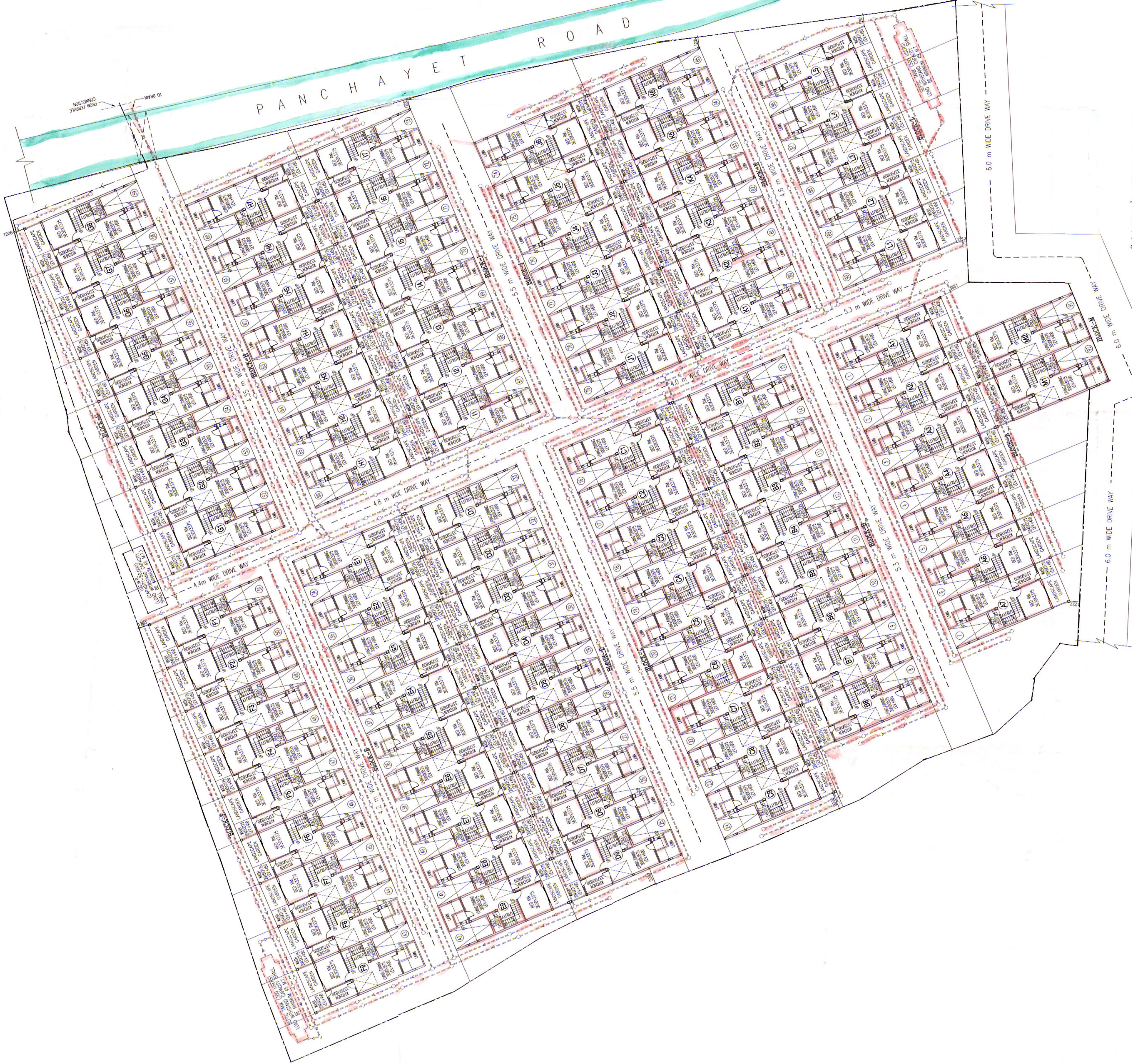

GROUND FLOOR PLAN
SCALE=1:200

Ref: No. issued by M.S. Government,
Kolkata, West Bengal, dated 11.11.2022.
Approved:
S. S. Saha, Panchayat
S. S. Saha, Panchayat

DOORS & WINDOWS SCHEDULE OF BUNGLOW

TYPE	SILL	UNTEL	SIZE	TYPE	SILL	UNTEL	SIZE
D1	-	2250	1100X2250	W1	275	2250	2100X1975
D2	-	2250	900X2250	W2	275	2250	1463X1975
D3	-	2250	825X2250	W3	900	2250	1400X1350
D4	-	2250	750X2250	W4	1050	2250	900X1200
DW1	-	2250	3000X2250	WS	600	1500X1650	1500X1650
		2250	2100X2250	V	1350	2250	600X900

—: AREA STATEMENT :-

LAND AREA = 11411.38 sq.m
 PROPOSED BUILDING HT. (G+1) = 6.7 m.
 PERMISSIBLE GROUND COVERAGE (65%) = 7417.397 sq.m
 PROPOSED GROUND COVERAGE (49.94%) = 5659.94 sq.m
 (43371463.95/87653.67/1000000) = 49.94% (43371463.95/87653.67/1000000)

SOUTH FACING BUNGLOW
BUILT-UP AREA OF BLOCK - A, C, E, H, J, L
 TOTAL GROUND FLOOR AREA OF ALL BUNGLOW = 2663.95 sq.m
 (4537.71+557.06+557.06+433.71+372.04+310.37)
 TOTAL 1ST FLOOR AREA OF ALL BUNGLOW = 2419.82 sq.m
 (393.97+505.96+505.96+337.97+337.96+281.96)
 TOTAL STAR HEAD ROOM AREA OF ALL BUNGLOW = 565.88 sq.m
 (13.16 X 43)
 PRO. TOTAL BUILT-UP AREA OF ALL BUNGLOW = 5649.65 sq.m
 (2663.95+2419.82+565.88)
 TOTAL NOS OF BUNGLOW = 43 NOS.

NORTH FACING BUNGLOW
(BLOCK - B, D, G, I, K & M)
 TOTAL GROUND FLOOR AREA OF ALL BUNGLOW = 3035.99 sq.m
 (495.38+557.06+557.06+495.38+433.71+372.04+125.36)
 TOTAL 1ST FLOOR AREA OF ALL BUNGLOW = 2757.79 sq.m
 (449.96+505.96+505.96+449.96+337.97+337.96+114.0)
 TOTAL STAR HEAD ROOM AREA OF ALL BUNGLOW = 644.84 sq.m
 (13.16 X 49)
 PRO. TOTAL BUILT-UP AREA OF ALL BUNGLOW = 6438.62 sq.m
 (3035.99+2757.79+644.84)
 TOTAL NOS OF BUNGLOW = 49 NOS.

PRO. TOTAL BUILT-UP AREA OF ALL BUNGLOW = 12088.27 sq.m
 (5649.65+6438.62)

CAR PARKING CALCULATION
 TOTAL NOS OF BUNGLOW (NORTH & SOUTH FACING) = 92 NOS.
 RECD. CAR PARKING = 92 NOS.
 PROVIDED CAR PARKING = 92 NOS.

GENERAL NOTES

1. ALL DIMENSIONS ARE IN MM.
2. ALL EXTERNAL WALLS 250TH. & INTERNAL WALLS 125 THK. UNLESS OTHERWISE MENTIONED.
3. ALL MASONRY WORKS ARE BOUNDED BY CEMENT MORTAR (1:1.6) & (1:4).
4. EXTERNAL PLASTER IS 25TH. & INTERNAL PLASTER IS 12MM. TH WITH 1:4 MORTAR.
5. ALL CONC. GRADE IS M200 (1:1.5:3).

CERTIFICATE OF STRUCTURAL ENGINEER

CERTIFIED THAT THE FOUNDATION AND SUPERSTRUCTURE OF THE BUILDING HAVE BEEN SO DESIGNED BY ME TO BE SAFE IN ALL RESPECTS INCLUDING THE CONSIDERATION OF BEARING CAPACITY OF SOIL.

SIGN. OF STRUCTURAL ENGINEER:

SIGN. OF ARCHITECT:

TITLE
GROUND FLOOR PLAN, DETAIL OF SEPTIC TANK & U.G.W.R.

PROJECT
PROPOSED (G+1) STORED (6.7 M) RESIDENTIAL APARTMENT OVER L.R. DAG NOS. 2463, 2464, 2465, 2466, 2467, 2468, 2469, 2472, 2473, 2474, 2475, 2476, 2477, 2478, 2479, 2480, 2481, 2482, 2483, 2484, 2485, 2486, 2489, 2491, 2492, 2493, 2494, 2495 AND 2496 RECORDED IN L.R. KHATTIAN NOS. 789, 2815, 2816, 1361, 231, 457, 635, 316, 638, 234, 1745, 1667, 424, 15, 636, 328, 847, 803, 531, 55, 1943, 133, 572/1, 831/1, 16/1, 1942, 2050, 842, 357, 156, 627, 234, 801, 761, 172 AND 4. MOUZA BAMUNARA, J.L. NOS. 58, POLICE STATION KANKSA, GOPALPUR GRAM PANCHAYAT, DISTRICT BURDWAN.

DATE 30.08.22
JOB NO. ARCH/2001/351
DEALT GARGI
CHECKED RAJ SIR
SHEET NO. 1 OF 3

SCALE
1:200 & 1:100

ARCHITECT
RAJ AGARWAL & ASSOCIATES
88, ROYD STREET
KOLKATA-16